



# THE SAN FRANCISCO-OAKLAND BAY BRIDGE SEISMIC SAFETY PROJECTS

CALTRANS

BAY AREA TOLL AUTHORITY

CALIFORNIA TRANSPORTATION COMMISSION



## EASTBOUND DETOUR TO BEGIN MEMORIAL DAY WEEKEND



Alignment change  
on the  
**BAY BRIDGE**

*Bay Bridge motorists should expect a slight alignment change as they approach Oakland*

### EASTBOUND DETOUR

Connecting the detour will not require a full-bridge closure. On Saturday, May 28 and Sunday, May 29, select eastbound lanes will be closed from 8 p.m. to 5 a.m.; eastbound traffic will still be able to cross the bridge. Westbound traffic will not be affected. The speed limit will remain the same and will be enforced.

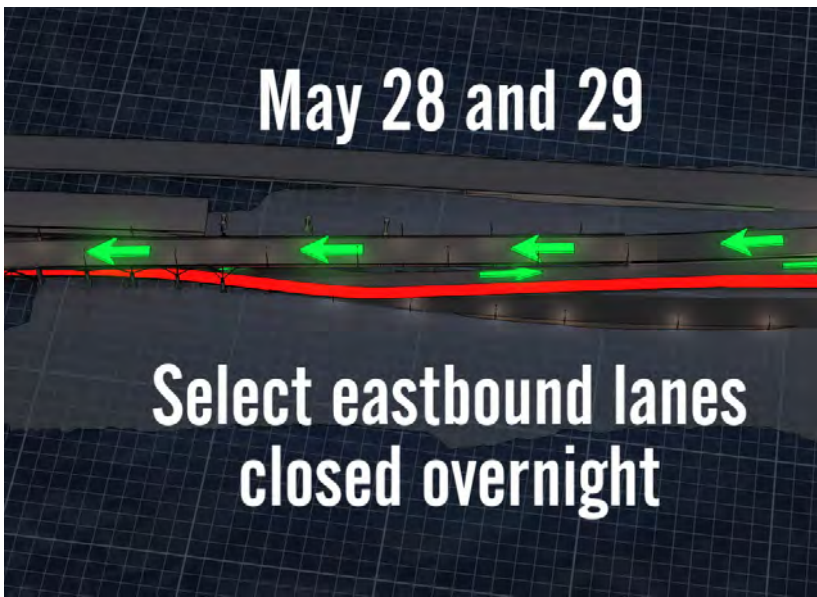

**May 28 and 29**

Select eastbound lanes  
closed overnight

### WHAT'S AHEAD

A westbound detour will be completed in early 2012. By implementing these detours near the Toll Plaza for the next two years, the entire bridge will open to the public earlier than previously scheduled. The detours will allow construction crews to work between the existing and new bridges to complete the new span's eastbound lanes, which is not possible without the traffic realignment.

FOLLOW US ON TWITTER (TWITTER.COM/BAYBRIDGEINFO)  
 AND FACEBOOK (FACEBOOK.COM/BAYBRIDGEINFO)

For more information, visit:  
Para esta información en español, por favor visite:  
如需更多中文資訊，請見：  
**BayBridgeInfo.org**

FOR REAL-TIME TRAFFIC CONDITIONS AND PUBLIC TRANSIT ALTERNATIVES, VISIT **511**  
511.ORG OR CALL 511

# EXPLORE THE FUTURE



## BAY BRIDGE EXPLORER

Experience the future of the Bay Bridge today in stunning 3D. The **Bay Bridge Explorer** mobile app drops you into the driver's seat and lets you cruise on the new East Span while construction is still underway. See how your drive across the Bay Bridge will change as we prepare to open the bridge in 2013. In the first edition, you can drive on a new and improved eastbound approach into Oakland that will shift traffic away from construction to allow crews to finish the new bridge faster. Bay Bridge Explorer is available for iPads, iPhones (4 and 3GS) and iPods (third and fourth generation iPod Touch, not including 8GB versions). To download the app, visit the App Store and search for **Bay Bridge Explorer**.

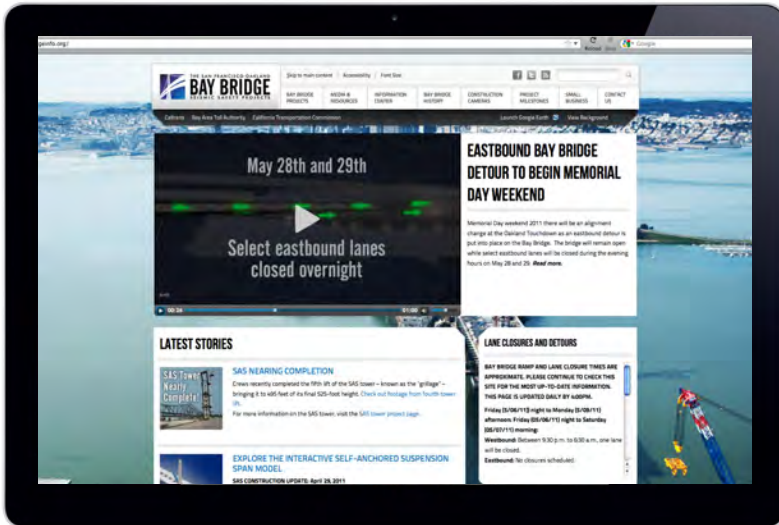

## THE NEW BAYBRIDGEINFO.ORG

The project website – **BayBridgeInfo.org** – has undergone an overhaul, and visitors will find a redesigned site that visually echoes the architecture of the new East Span's signature element, the Self-Anchored Suspension Bridge. The media-rich site offers a more interactive and immersive experience including larger galleries of hi-resolution photos and videos. The website also incorporates the Webby-Award winning **BayBridge360** and **Google Earth**, which features the new Bay Bridge as the first construction project on Google Earth.



## DETOUR MICRO-SITE

A dedicated page within BayBridgeInfo.org is replete with detour details, fact sheets and computer animations of the detour construction and the eastbound drive-through, as well as instructions on how to download the mobile app Bay Bridge Explorer. Find out more at **BayBridgeInfo.com/otd\_detour**.

Learn more about the Oakland Touchdown Detours by scanning this QR tag with your smartphone or other personal media device using QR reader apps that are available online.

